

IGS



EPIC LINK

Operator Manual

Table of Contents

1. Hardware.....	2
Hardware Connection	2
Connecting Touch Panel.....	3
Power Supply Specifications.....	5
36 & 10 PIN Button Layout.....	5
Reset.....	6
Grand Jackpot Range Setting	8
2. Bookkeeping & Adjustment	10
Access Flow Chart	10
System Setup Configure	11
Reports.....	12
Devices.....	13
Touch Screen Calibration.....	14
Log Menu	15
3. Introduction.....	16
Common Features	16
Lobby.....	16
(Game 1) TRIPLE PIGGY VAULT	17
(Game 2) DRAGON BABY.....	18
(Game 3) BOXING KING	19
(Game 4) LUCKY RICHES	20
(Game 5) CASH KING	21

1. Hardware Hardware Connection

10-Pins Connector

36-Pins Connector

Audio Jack

DIP Switch

DVI

D-Sub

HDMI

Bill Acceptor

RS-232 Touch

Printer

USB

LAN

+5V Power

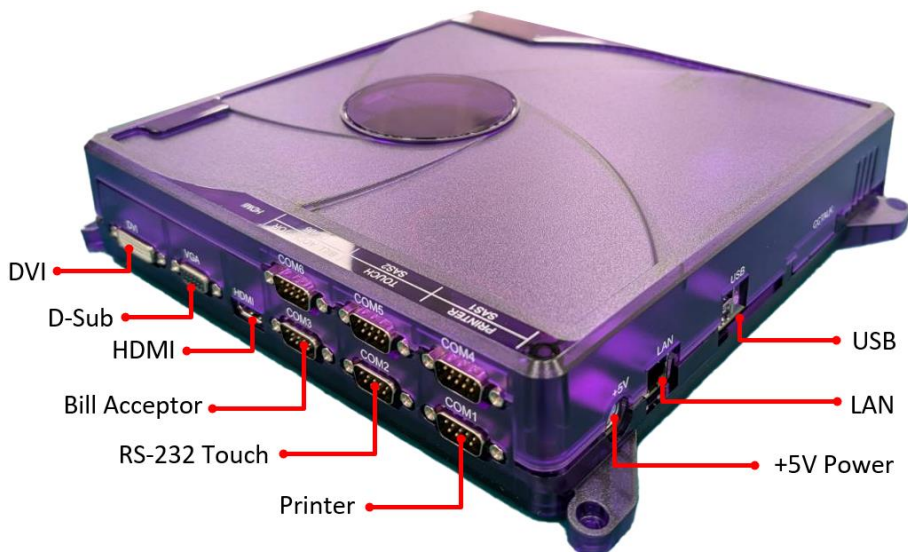

Connecting Touch Panel

- Please refer to the diagram below to connect the touch screen.
- Please make sure that the touch screen is well-connected before operation.
- The resolution of this game is Full HD. Please confirm that the monitor supports Full HD resolution.



RS-232 Touch



Connection Diagram

36 Pins		
PARTS SIDE		SOLDER SIDE
	1	
	2	
SPEAKER_L	3	
	4	
	5	SPEAKER GND
	6	
	7	
	8	
START / ALL STOP	9	
	10	START / ALL STOP
	11	MAIN DOOR SW
	12	SPEAKER_R
	13	STACKER DOOR SW
	14	LOGIC DOOR SW
	15	BELLY DOOR SW
	16	LAMP: CASHOUT
	17	
BILL IN (PULSE)	18	KEY IN
	19	
RECORD	20	TEST
	21	CASH OUT
	22	
IN METER	23	
	24	
COUNT METER	25	
	26	
	27	
OUT METER	28	
	29	
	30	
	31	LAMP: START
	32	
	33	
	34	
	35	
SPEAKER GND	36	GND

10 Pins		
PARTS SIDE		SOLDER SIDE
GND	1	GND
GND	2	GND
+5V	3	+5V
+5V	4	+5V
+12V	5	+12V
	6	
	7	
	8	
GND	9	GND
GND	10	GND

Power Supply Specifications

- **Single Source Requirement:** The board must be powered by a **single power supply** that provides both 5V and 12V outputs simultaneously.
- **Operating Voltage & Recommended Current:**
 - +5V Voltage Range: 4.5V ~ 5.3V** (Recommended Current: 2A or greater)
 - +12V Voltage Range: 10.4V ~ 13.2V** (Recommended Current: 5A or greater)
- [Troubleshooting] If the game fails to start properly, please check the following:
 - Is the input voltage within the specified range?
 - Does the power supply provide sufficient current (amperage)?

36 & 10 PIN Button Layout

2 Buttons



Reset

1. Press **【RECORD】** button to enter 「Backend」 page.
2. Press 「System Setup」 .

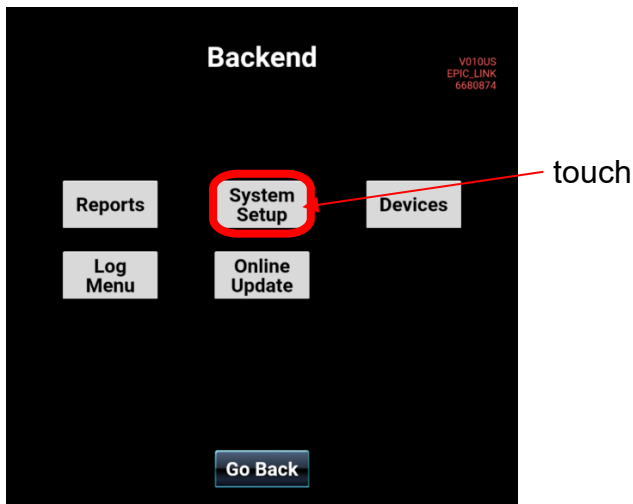

3. Select 「RESET」 page.

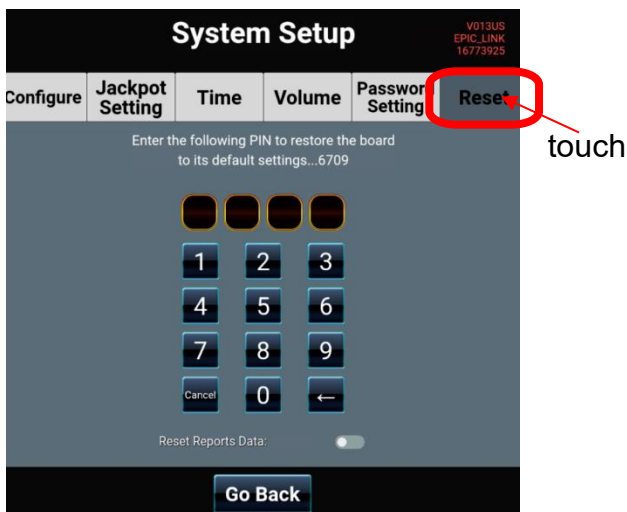

4. Enter the following PIN to confirm **RESET**.



5. Please reboot the machine after **RESET** is completed.

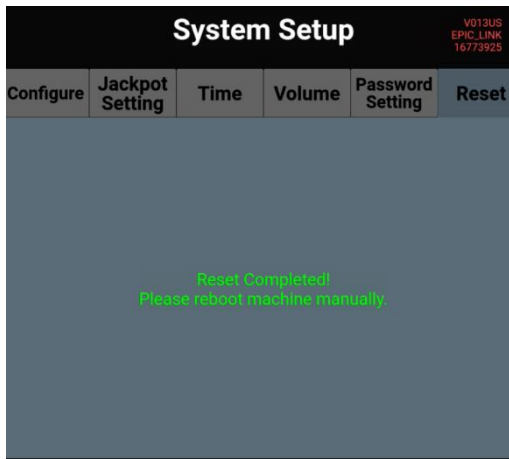

Jackpot Setting

1. Press **【RECORD】** button to enter 「Backend」 page.
2. Press 「System Setup」.

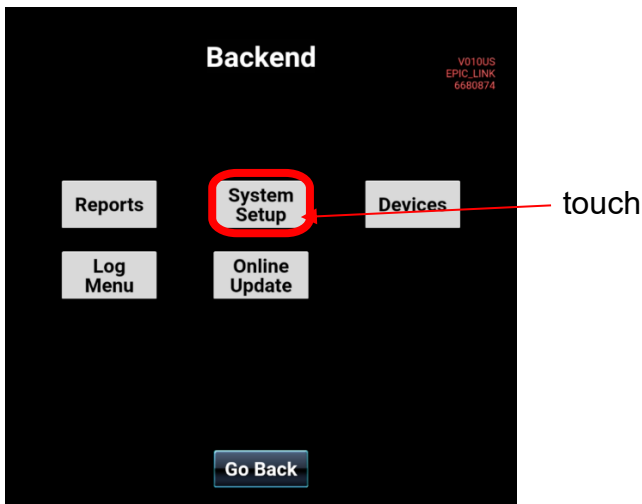

3. Select 「Jackpot Setting」 page.

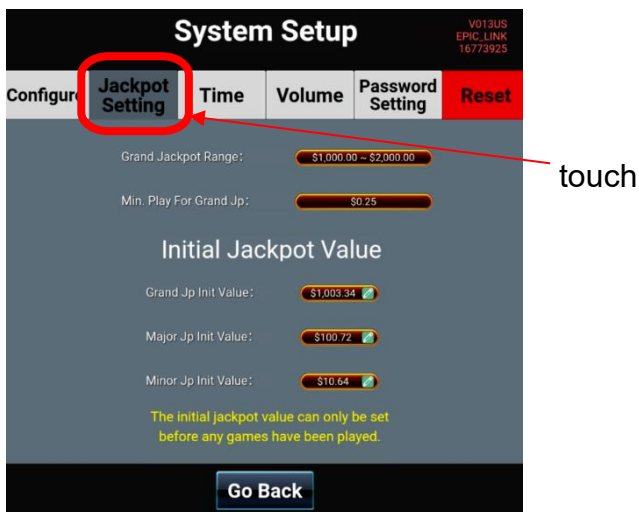

4. Press 「Grand Jackpot Range」 to set Jackpot level.



The base value for each jackpot is listed in the table below.

Grand	Major	Minor
\$500	\$50	\$5
\$1,000	\$100	\$10
\$2,000	\$200	\$20
\$3,000	\$300	\$30

5. Select one of the Grand Jackpot Range, then press 「Go Back」 to apply the settings.

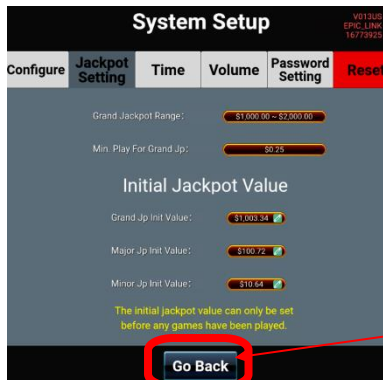

touch

2. Bookkeeping & Adjustment

Access Flow Chart

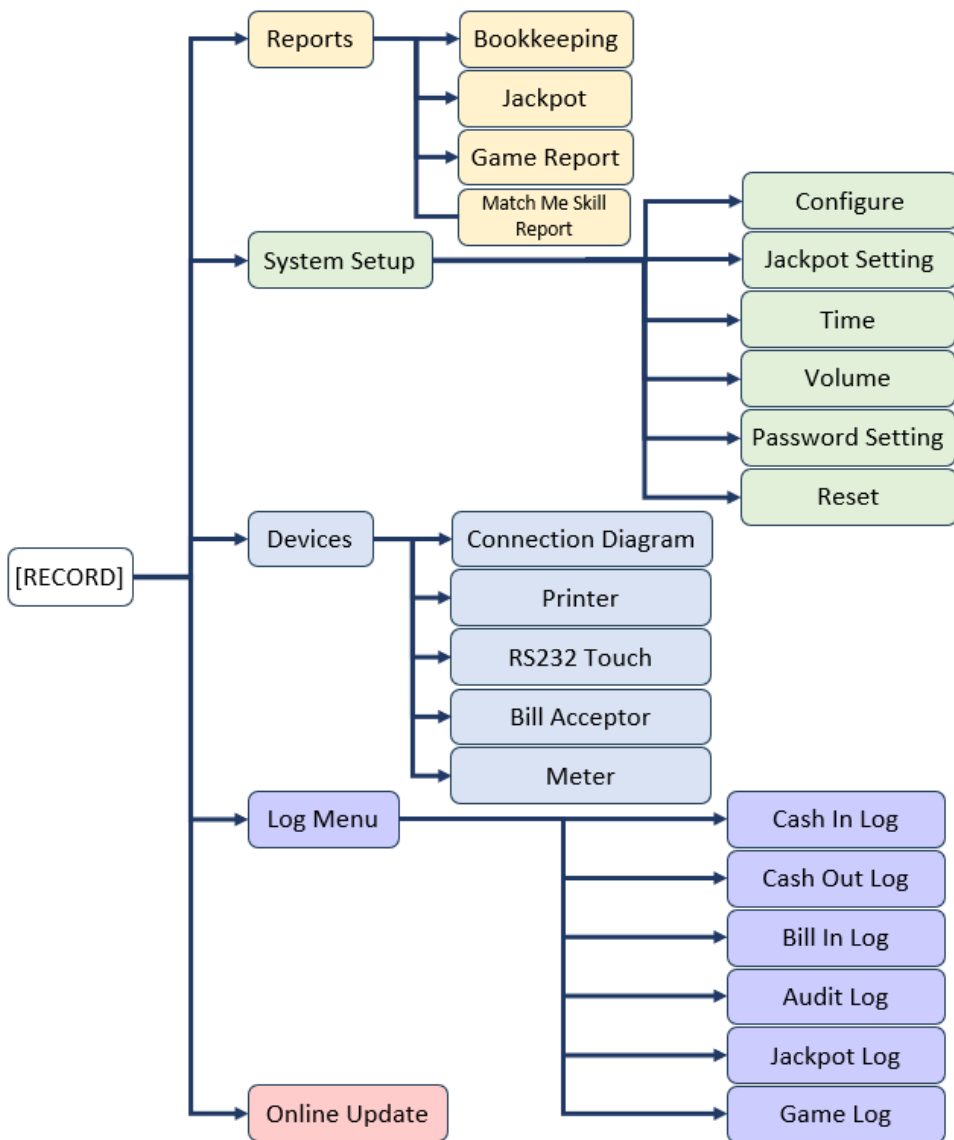



System Setup Configure

ITEMS	SETTING SELECTION	DEFAULT
Grand Jackpot Range	\$500.00 ~ \$1000.00 , \$1000.00 ~ \$2000.00 , \$1000.00 ~ \$3000.00 , \$1000.00 ~ \$4000.00 , \$2000.00 ~ \$3000.00 , \$2000.00 ~ \$4000.00 , \$2000.00 ~ \$5000.00 , \$3000.00 ~ \$4000.00 , \$3000.00 ~ \$5000.00 , \$3000.00 ~ \$6000.00	\$1000.00 ~ \$2000.00
Min Play For Grand Jp	\$0.25, \$0.50, \$1.00, \$2.00,	\$0.25
MAX. PLAY(TOTAL)	\$3.00, \$4.00, \$5.00	\$5.00
MIN. PLAY(TOTAL)	\$0.25, \$0.50, \$1.00	\$0.25
Out Meter Rate	\$0.00, \$0.01, \$0.04, \$0.05, \$0.10, \$0.15, \$0.20, \$0.25, \$0.50, \$0.75, \$1.00, \$2.00, \$3.75, \$5.00, \$10.00	\$1.00
Cash Out Unit	\$0.01, \$0.04, \$0.05, \$0.10, \$0.15, \$0.20, \$0.25, \$0.50, \$0.75, \$1.00, \$2.00, \$3.75, \$5.00, \$10.00	\$1.00
Spin Before Cashout	OFF, ON	OFF
Show Last Voucher	OFF, ON	OFF
Display Format	Dollar, Credit	Dollar
Auto Play	OFF, ON	OFF
Chance Level	Very Low, Low, Medium, High	Very Low
Score Box	OFF, ON	OFF
Play Score	OFF, ON	OFF
Hand Count	OFF, ON	OFF
Hand Count Amount	\$1.00, \$5.00, \$10.00	\$1.00
Confirm Cashout	OFF, ON	ON
Prize Viewer	OFF, ON	OFF
Cashout Limit	OFF, ON	OFF
Cashout Limit Amount	\$1.00 ~ \$1000.00 (Custom)	\$1.00
Meter Game	OFF, ON	OFF
Match Me Skill Game	OFF, ON	OFF

Reports

1. Press **[RECORD]** button to enter 「Backend」 page.
2. Press 「Reports」. There are 3 pages: **Bookkeeping**, **Jackpot**, and **Game Report**.

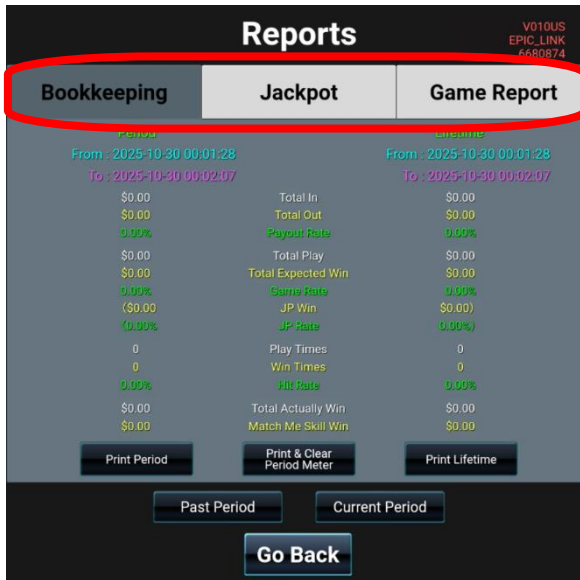

[Bookkeeping]

- Displays complete accounting data.
- Provides functions for printing/clearing period numbers and printing lifetime numbers.

[Jackpot]

- Displays the number of hits and total payout amounts for all jackpots.

[Game Report]

- Provides key accounting meters (or basic accounting data) for each game.

Devices

1. Press **[RECORD]** button to enter 「Backend」 page.
2. Press 「Devices」. There are 5 pages: **Connection Diagram**, **Printer**, **RS232 Touch**, **Bill Acceptor**, and **Meter**.

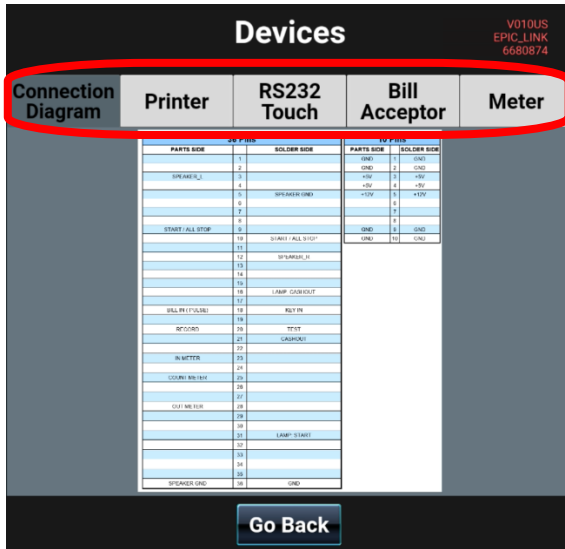

[Connection Diagram]

- For detailed wiring and connection information, please refer to **page 4**.

[Printer]

- Allows configuration of settings for different printer devices.

[RS232 Touch]

- Allows calibration of touch screen.

[Bill Acceptor]

- Allows setting of communication protocol to Pulse or RS232 as required.

[Meter]

- Allows adjustment of the meter counter speed to Normal, Medium, or Fastest.

Touch Screen Calibration

1. If a touch screen is connected, press 「DEVICES」 > 「RS232 Touch」 and follow the prompts to enter the calibration screen.
2. Touch center of the cross.
3. Follow the cross when it moves until the calibration is completed.



Log Menu

1. Press **[RECORD]** button to enter 「Backend」 page.
2. Press 「Log Menu」. There are 6 types of logs listed below. **Each log stores the latest 100 records.**

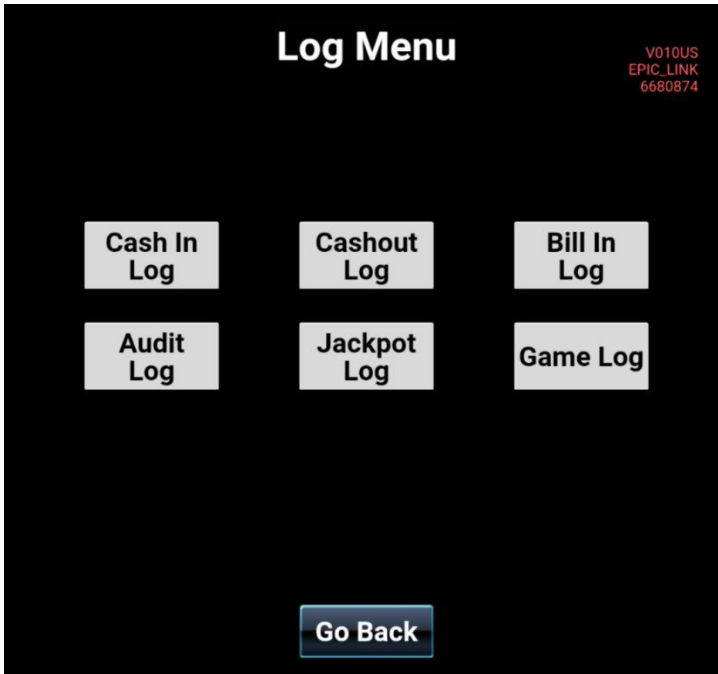

Cash In Log: Displays all money in records in chronological order.

Cash Out Log: Displays all money out records in chronological order.

Bill In Log: Displays all bills accepted for each denomination.

Audit Log: Displays all audit-related event records.

Jackpot Log: Displays all Jackpot-related records.

Game Log: Displays game history and last play screen.

EPIC LINK

3. Introduction

Common Features

- Single Line / 25,30,80 lines / All ways
- Free Game / Bonus Game / Feature
- Shared Progressive Jackpot
- Touch Screen / Score Box / Hand Count support

Lobby

Epic Link is a 5 in 1 slot multigame.

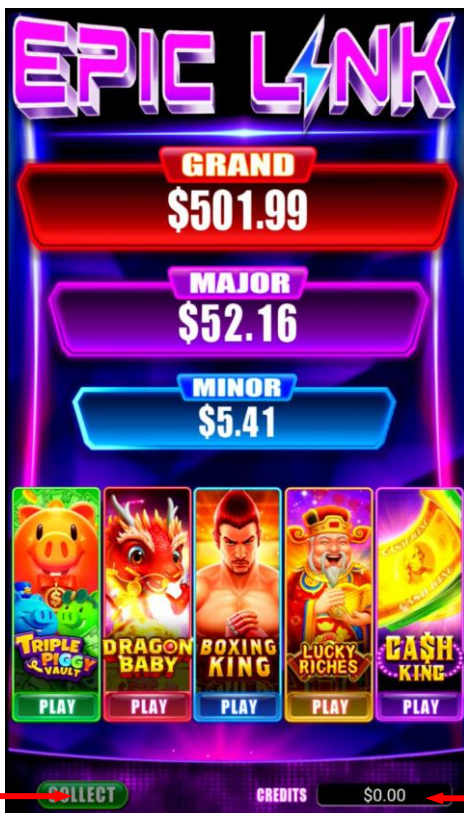

Collect Button

Credits

(Game 1) TRIPLE PIGGY VAULT



- This is a 5x3 reel, 25-payline game.
- 3 colors of Piggy Coins correspond to 3 different Free Game features. These features may be triggered simultaneously.
- Collecting Piggy Coins not only triggers Free Game, but also upgrades the features:
- [Yellow Coin] Increases prize values of MEGA, LEGEND, EPIC, RICH, CLASSIC, and ROOKIE bonus.
- [Blue Coin] Awards additional Free Spins.
- [Green Coin] Removes smaller symbol(s) from the reels.

EPIC LINK

(Game 2) DRAGON BABY



- This is a 5x3 reel, 30-payline game. In addition, Gold Ingot symbols pay when appearing on adjacent reels from left to right.
- 3 colors of Dragon Coins correspond to 3 different Free Game features. These features may be triggered simultaneously.
- No matter which feature is triggered first, the other two features may be triggered during Free Game.
- [Green Dragon Feature] Awards additional Free Spins.
- [Red Dragon Feature] Transforms regular symbols into Gold Ingot symbols, with a chance to reveal Jackpot Gold Ingots.
- [Blue Dragon Feature] Expands the reels to 5x5 with 50 paylines and adds Multiplier Gold Ingots.

(Game 3) BOXING KING



- This is a 5x5 reel, 80-payline game featuring **Cascading Reels**. Winning symbols will be removed, allowing new symbols to drop into place for **multiple winning opportunities on a single spin**.
- **3 Scatter symbols award 8 Free Spins**.
- During **Free Game**, every **combo** (or *cascade*) **increases the winning multiplier**.

EPIC LINK

(Game 4) LUCKY RICHES



- This game features **two 5x3 reel sets**, each with **243 Ways** to win. Both reel sets pay independently.
- **6 or more Scatter symbols** on either reel set trigger the **LUCKY RICHES FEATURE**, which is a **Respin** game.
- During Respin feature, **filling all 15 positions** (on one of the reel sets) with Scatter symbols will unlock the **Multiplier Wheel**.
- On the Multiplier Wheel, there is a chance to win **EPIC!**

(Game 5) CASH KING



- This is a 4-reel, 1-payline game.
- Reel 1, 2, and 3 display digits. When the reel stops spinning, the number formed on the payline will be the prize.
- The 4th reel contains Multipliers and the **Banknote symbol**:
- [Multiplier] Will be applied to the prize won on reel 1-3.
- [Banknote symbol] Triggers Pick Game. Play higher for larger prizes.



INTERNATIONAL GAMES SYSTEM CO.,LTD.

TEL:886-2-2299 5048

<https://www.sales-igs.com/>